

DURANEONFLEX

TOP FLEX

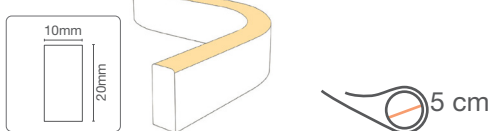

VERT FLEX



Z può essere T (Top Flex) o V (VERT Flex)
The Z may be T (Top Flex) or V (VERT Flex)

Y può essere A, B o C, che rappresenta il tipo di terminale utilizzato:
A Terminale in linea, B Terminale laterale, X Terminale posteriore.
The Y may be A, B or C, shown which terminal is used:
A is Line/straight terminal, B is Side/lateral terminal, X is Rear/bottom terminal.

Possono essere aggiunte 4 cifre, che rappresentano la lunghezza della striscia (per es. 1000 equivale a 10m).
4 digits can be added, which represent the length of the strip (for example, 1000 is 10m).

09UZ24XXXXEX-Y0000

Le seconde XX possono essere 27,30,35,40 o 60 (rappresentando i Kelvin); oppure le stesse possono essere RD,VR,GL,OR,BL,AM o PI, (rappresentando il colore).
The second XX may be 27,30,35,40 or 60, shown Kelvin; or the second XX may be RD,VR,GL,OR,BL,AM or PI, shown colour.

Le prime XX possono essere 09 o 14, rappresentano il wattaggio al metro.
The first XX may be 09 or 14, shown wattage per meter.

Nota: cavo di ingresso collegato all'alimentazione DC24V, linea rossa per la linea positiva e nera per il negativo.
Note: Input wire connected to DC24V power supply, red line for positive and black line for negative.

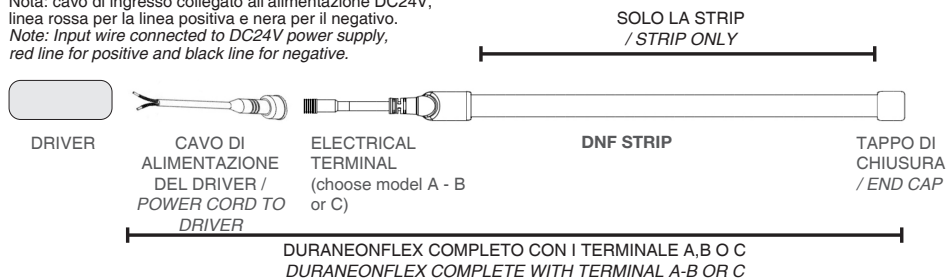

I - L'APPARECCHIO DEVE ESSERE INSTALLATO DA PERSONALE QUALIFICATO. L'AZIENDA DECLINA OGNI RESPONSABILITÀ QUALORA L'INSTALLAZIONE NON AVVENGA SECONDO LE NORME VIGENTI. METODO DI ATTACCO DEL CAVO TALE PER CUI LA SUA SOSTITUZIONE NON PUÒ ESSERE EFFETTUATA SENZA ROMPERE O DISTRUGGERE L'APPARECCHIO. LASCIARE UNA COPIA DI QUESTE ISTRUZIONI AL RESPONSABILE DELLA MANUTENZIONE. CONSERVARE L'ETICHETTA DELL'IMBALLO ORIGINALE PER EVENTUALI RECLAMI FUTURI.

GB - THIS FIXTURE MUST BE INSTALLED BY A QUALIFICATED ELECTRICIAN. DURALAMP IS NOT RESPONSIBLE IF ITS FIXTURES ARE NOT INSTALLED ACCORDING TO LOCAL SAFETY STANDARDS. METHOD OF ATTACHMENT OF THE CABLE OR CORD SUCH THAT IT CANNOT BE REPLACED WITHOUT BREAKING OR DESTROYING THE LUMINAIRE. PLEASE LEAVE A COPY OF THESE INSTRUCTIONS TO THE PERSON RESPONSABLE FOR THE MAINTENANCE OF THE INSTALLATION. KEEP THE LABEL OF THE ORIGINAL PACKING FOR THE EVENTUAL FUTURE CLAIMS

F - L'APPAREIL DOIT ETRE INSTALLE PAR ELECTRICIENS QUALIFIES. DURALAMP NE PEUT PAS ETRE RESPONSABLE POUR TOUTES INSTALLATIONS QUI NE RESPECTENT PAS LES NORMES DE SECURITE EN VIGUER. METHODE D'ATTACHE DU CABLE TELLE QUE SA SUBSTITUTION NE PEUT SE FAIRE SANS DETRUIRE L'APPAREIL. LAISSER UNE COPIE DE CES INSTRUCTIONS AU RESPONSABLE DE L'ENTRETIEN DU SYSTEME. GARDER L'ETIQUETTE DE L'EMBALLAGE ORIGINAL POUR EVENTUELLES RECLAMATIONS FUTURES.

D - DAS GERÄT MUSS VON ELEKTROINSTALLATEUREN MONTIERT WERDEN. DURALAMP IST NICHT VERANTWORTLICH WENN DIE MONTAGE NICHT GEMÄß DER SICHERHEITSVORSCHRIFTEN STÄTTFINDET. TED KABELANSCHLUSS SO AUSFÜHREN, DASS DAS KABEL NICHT OHNE DIE LEUCHTE ZU ZERSTÖREN GEWECHSELT WERDEN KANN. DIESES HINWEISBLATT MUß VOM INSTANDHALTUNGSLEITER AUFBEWAHRT WERDEN. BEI REKLAMATIONEN BITTE DEN ARTIKELAUFLÄBER AUS DER LEUCHTENVERPACKUNG BEIFÜGEN.

E - EL APARATO DEBE SER INSTALADO POR ELECTRICISTAS CUALIFICADOS. DURALAMP NO SE RESPONSABILIZARA DE TODAS LAS INSTALACIONES QUE NO RESPETEN LAS NORMAS DA SEGURIDAD EN VIGOR. METODO DE FIJACION DEL CABLE CUYA SUSTITUCION NO PUEDE REALIZARSE SIN ROMPER O DESTRUIR EL DISPOSITIVO. ENTREGAR UNA COPIA DE ESTAS INSTRUCCIONES AL RESPONSABLE DE LA INSTALACION. ONSERVAR LA ETIQUETA DEL EMBALAJE ORIGINAL PARA POSIBLES RECLAMACIONES.

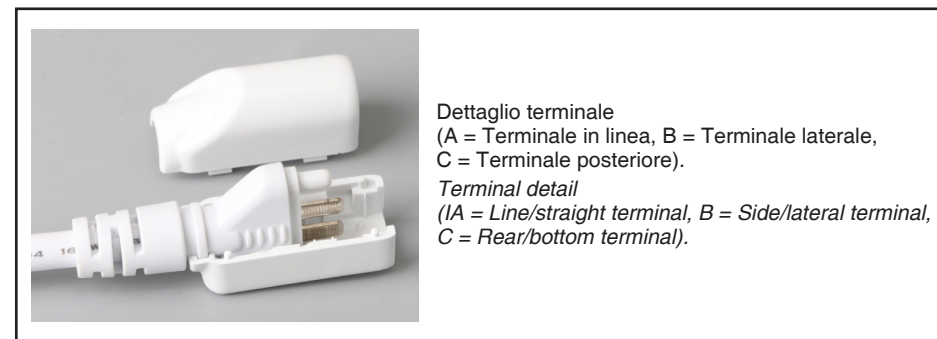

RG0

RG0 secondo norma IEC/TR 62778:2014 / RG0 in accordance with IEC/TR 62778:2014
RG0 selon la norme IEC/TR 62778:2014 / RG0 nach der norm IEC/TR 62778:2014
RG0 enlight IEC/TR 62778:2014 / RG0 volgens IEC/TR 62778:2014
RG0 de acordo com norma IEC/TR 62778:2014 / RG0 po predpisu IEC/TR 62778:2014

Duralamp S.p.A.

Via Pratese, 164 - 50145 Florence - Italy

TOP Flex

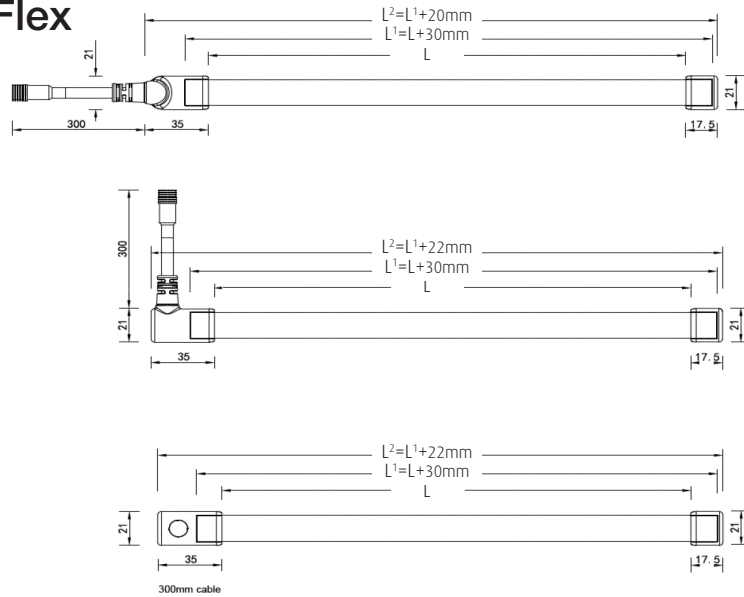

Installazione VERT Flex Strips/VERT Flex Strips Installation:

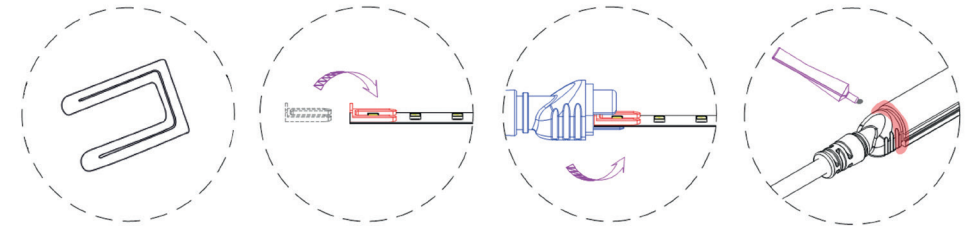

Protezione del chip LED / PCB protection.

Inserire la protezione sopra alla striscia per evitare lo schiacciamento del chip/Insert protection on the strip to avoid chip crushing.

Inserire il connettore sul retro della striscia (se inserito sopra alla striscia si danneggia il LED) / Insert the connector on the back of the strip (if it is inserted above the strip, the LED will be damaged).

Aggiungere la colla nell'apposita scanalatura per sigillare / Seal the item by adding glue into the groove.

VERT Flex

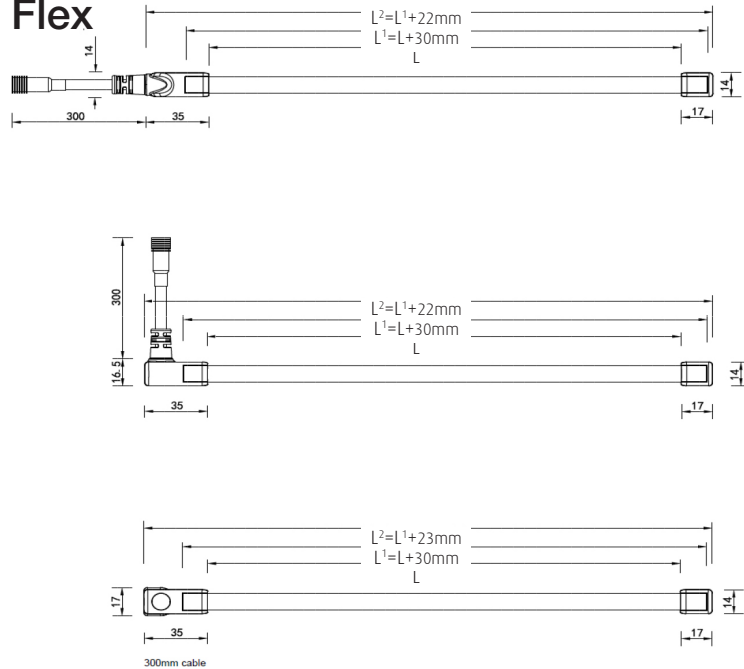

Terminale in linea Line/straight terminal

cod.KT09UVL1

cod.KT09UVRGBL1
(solo per striscie RGB/only for RGB strips)

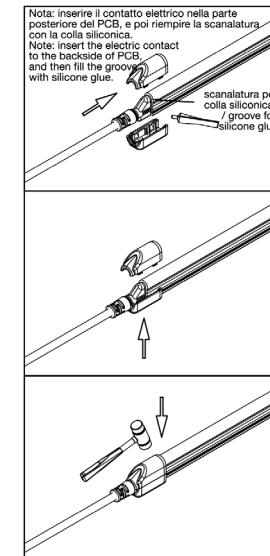
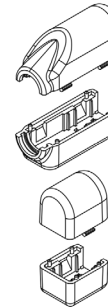

1

2

3

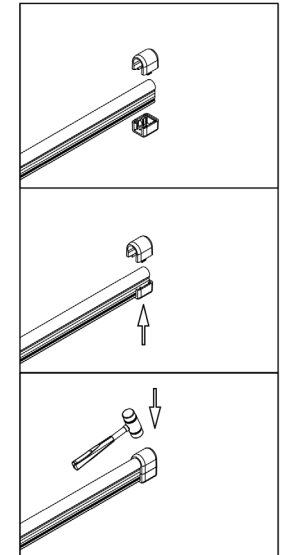

Per maggiori dettagli tecnici visita il sito / For more technical details please check our website / Pour plus de détails techniques, visitez le site Web / Für weitere technische Details, besuchen Sie unsere Website/Para más detalles técnicos, visite nuestro sitio web/ Več tehničnih informacij na voljo na spletni strani:

www.duralamp.it

Installazione TOP Flex Strips/TOP Flex Strips Installation:

Terminale laterale
Side/lateral terminal

cod.KT09UJL2

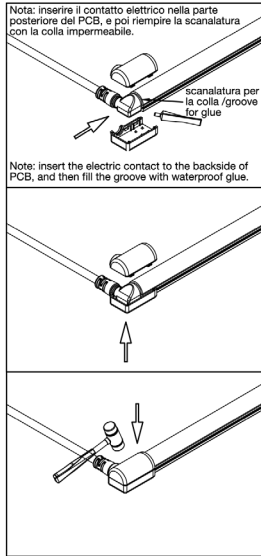
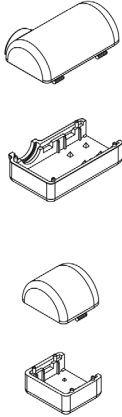

1

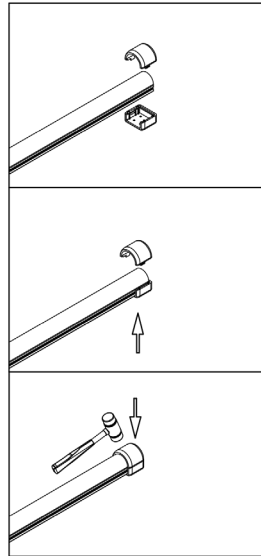

2

3

Terminale laterale
Side/lateral terminal

cod.KT09UJL2

cod.KT09UVRGBL2
(solo per strisce RGB/only for RGB strips)

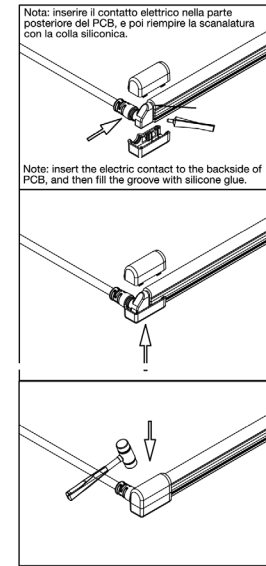
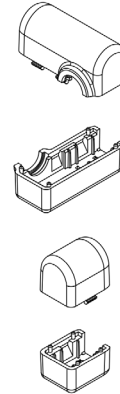

1

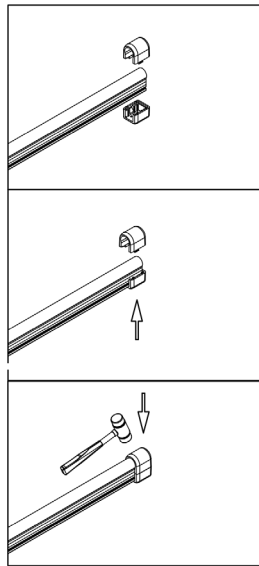

2

3

Terminale posteriore
Rear/bottom terminal

cod.KT09UJL3

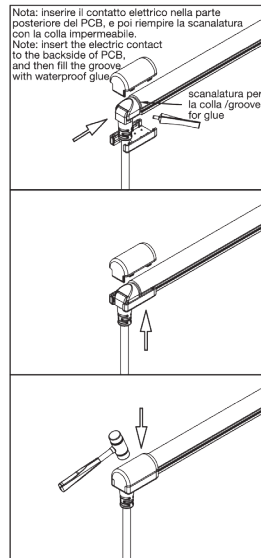
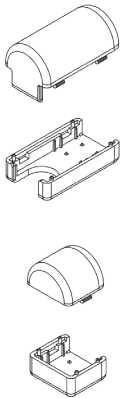

1

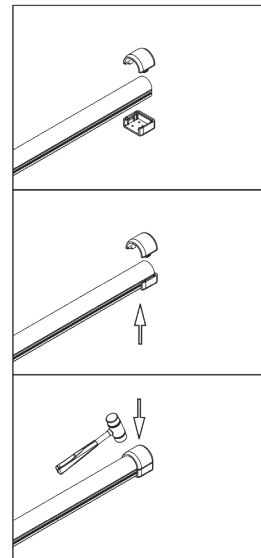

2

3

Terminale posteriore
Rear/bottom terminal

cod.KT09UJL3

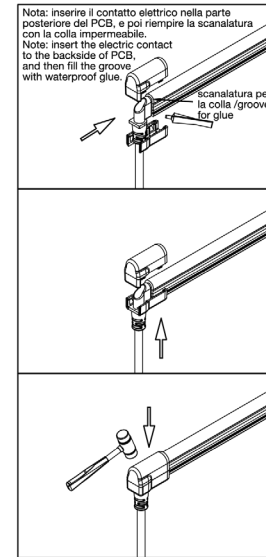
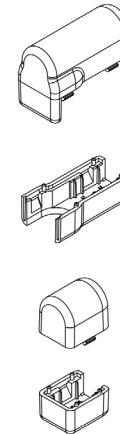

1

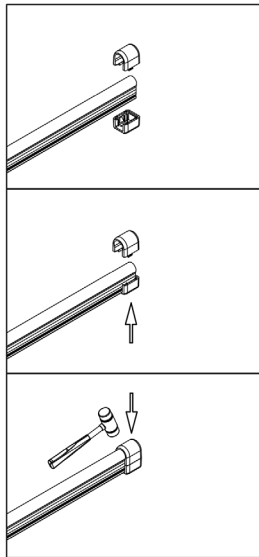

2

3

**Giunzione (step opzionale)
Junction (optional step)**

cod.KT09UTJ1

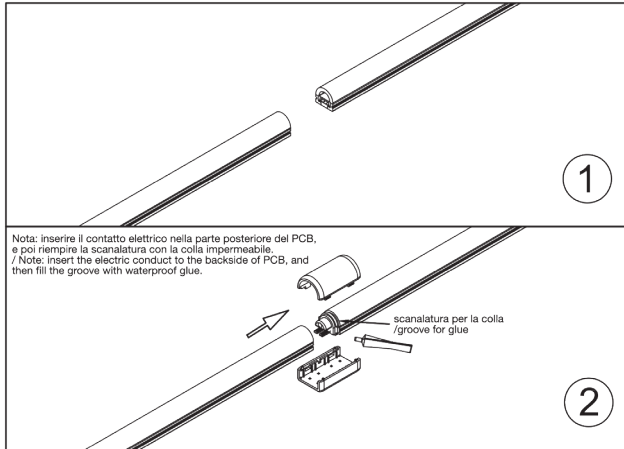
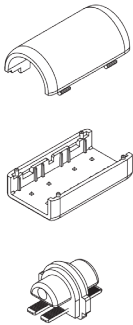

Installazione TOP Flex Strips/TOP Flex Strips Installation:

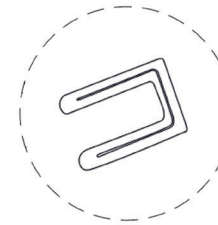

Protezione del chip LED
/ PCB protection.

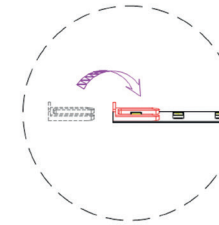

Inserire la protezione sopra alla striscia per evitare lo schiacciamento del chip/Insert protection on the strip to avoid chip crushing.

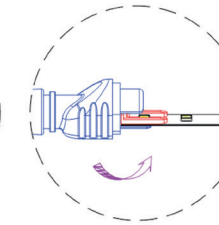

Inserire il connettore sul retro della striscia (se inserito sopra alla striscia si danneggia il LED) / Insert the connector on the back of the strip (if it is inserted above the strip, the LED will be damaged).

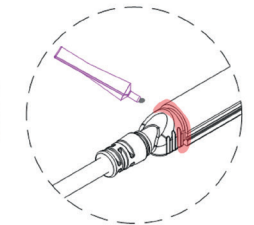

Aggiungere la colla nell' apposita scanalatura per sigillare / Seal the item by adding glue into the groove

**Terminale in linea
Line/straight terminal**

cod.KT09UTL1

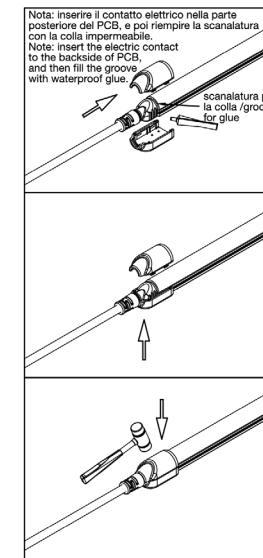
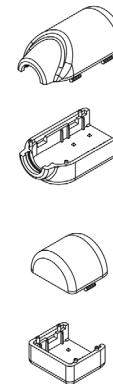

1

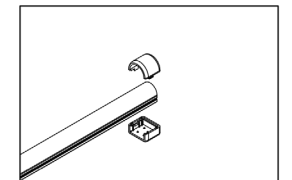

2

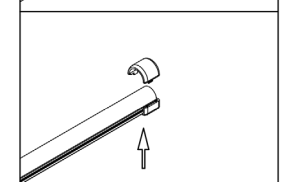

3

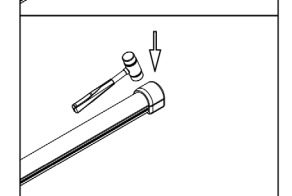

KIT accessories DURANEONFLEX



KT09UVL1

Terminale in linea per Vert flex / Straight terminal for Vert flex / Terminal en línea para Vert flex / Terminaison en ligne pour Vert flex / Anschluss in Reihenverbund für Vert flex



KT09UVL2

Terminale laterale per Vert flex / Lateral terminal for Vert flex / Terminal lateral para Vert flex / Terminaison en ligne pour Top flex / Seitlicher Anschluss für Vert flex



KT09UVL3

terminal for Vert flex / Terminal inferior para Vert flex / Terminaison inférieure pour Vert flex / Anschluss unten für Vert flex



KT09UVS1

Clip di fissaggio per Vert flex / Fixing clips for Vert flex / Clip de fijación para Vert flex / Clip de fixation pour Vert flex / Befestigungsclips für Vert flex

KT09UTS1

Clip di fissaggio per Top flex / Fixing clips for Top flex / Clip de fijación para Top flex / Clip de fixation pour Vert flex / Befestigungsclips für Top flex