

INSTALLATION MANUAL

12130D



90
CRI

CE EAC UK
CA



NOT
DIMMABLE

230V | SMD LED | 30W | IP44 | Aluminium
Complete with 750mA driver.

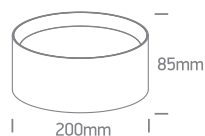
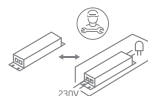

one
LIGHT

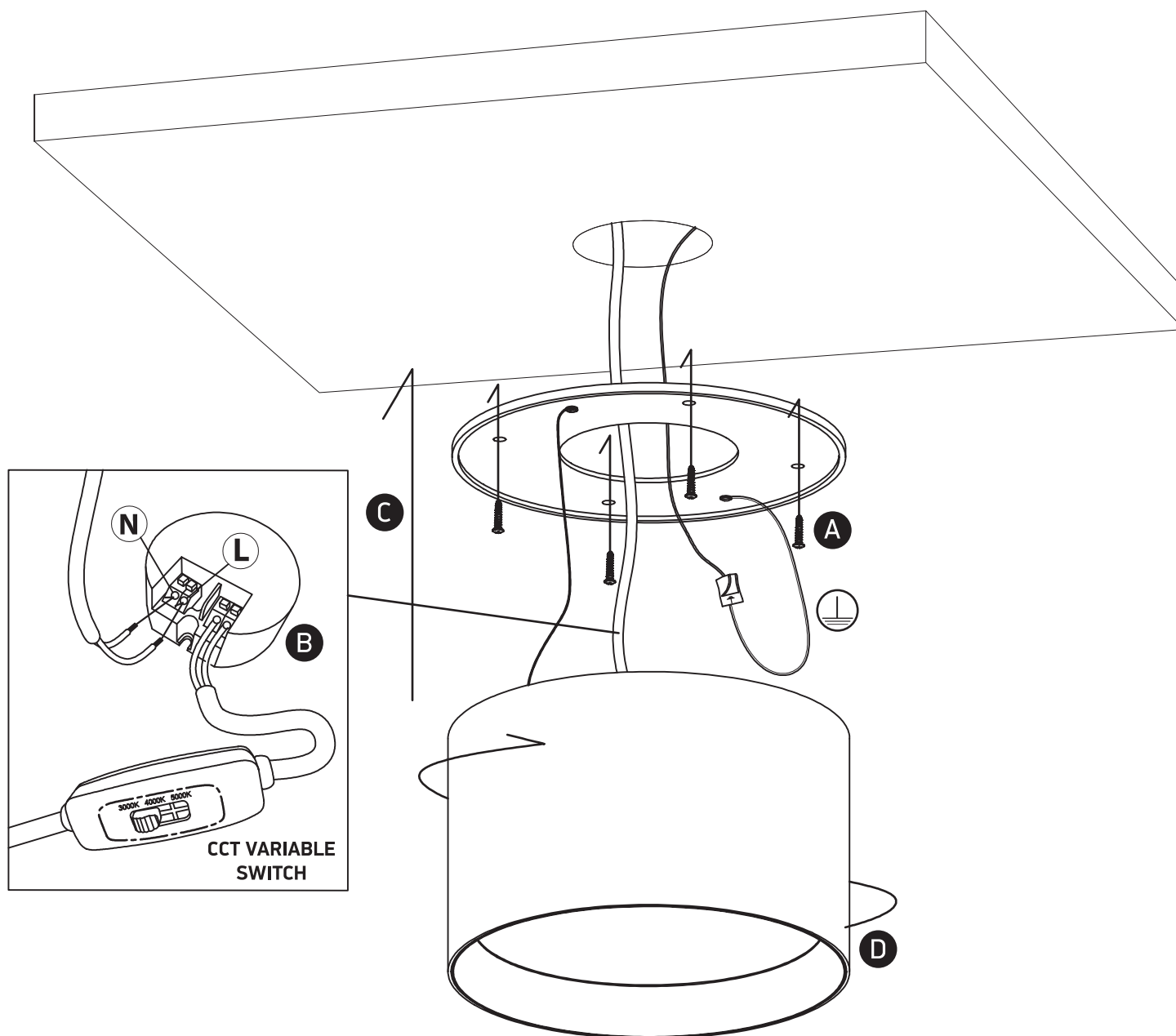

Warnings:

1. Fix the base on the ceiling.
2. Make sure that the product is installed properly before connecting to electricity.
3. Connect the AC power cable to the driver's cable as shown in the above diagram.
4. Do not cover the fitting.
5. Maintenance and installation should only be carried out by a professional electrician.