

IP66
IP69 (80°C)

220-240V
50/60Hz

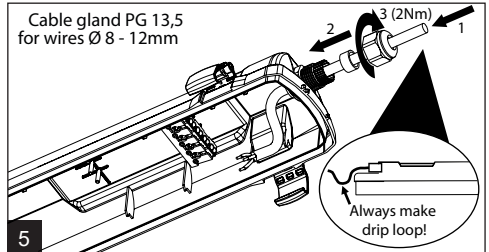

IP66
IP69 (80°C)

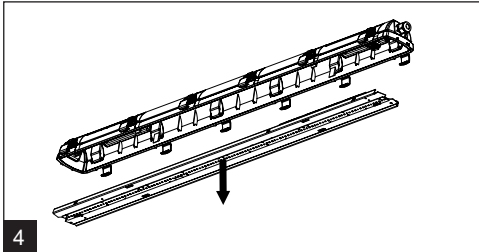
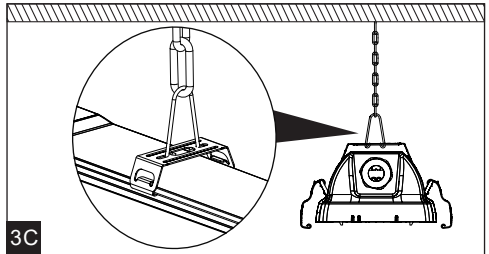
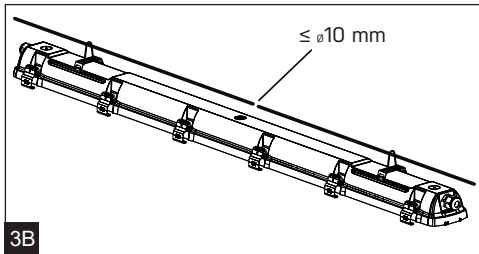
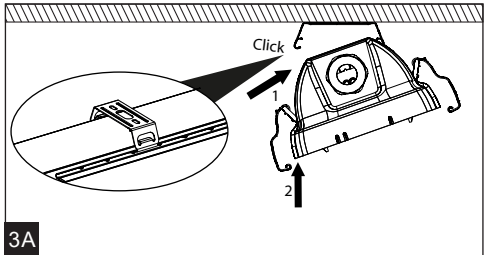
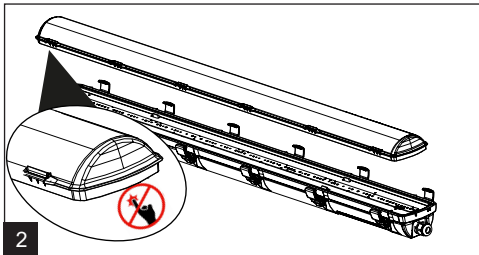
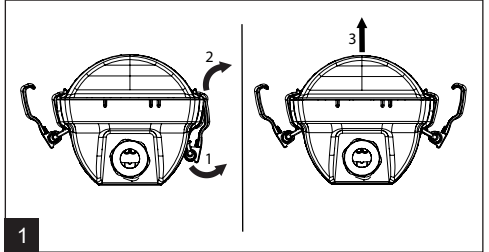
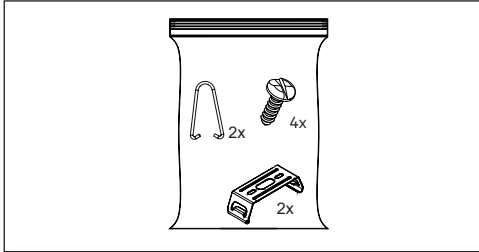
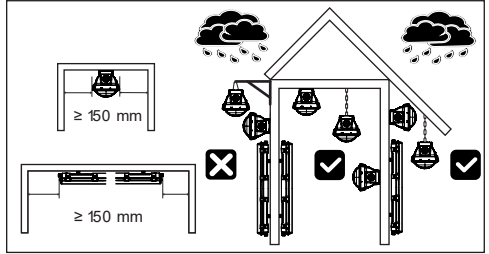
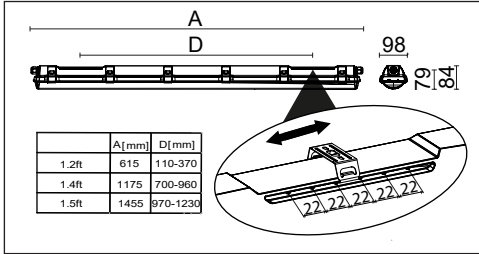
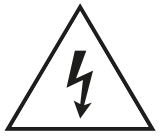

220-240V
50/60Hz

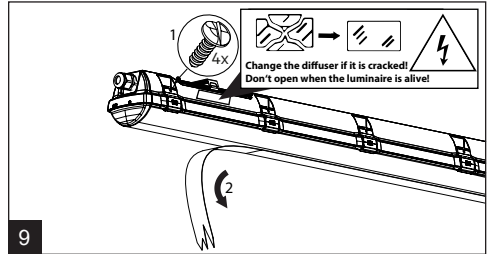
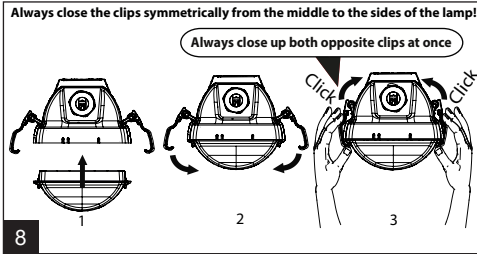
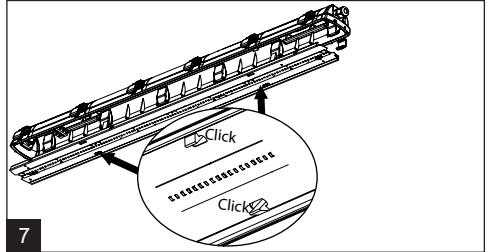
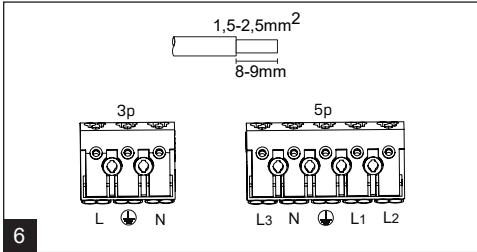
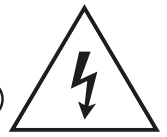

Installation can only be carried out by an authorized person and according to the mounting instructions. Any other installation is considered to be improper. For well installation and good luminaire work is necessary ensure a planarity of a mounting surface. Make sure that the luminaire is always disconnected from the power supply before the installation work. Do not use the luminaire if damaged or if damaged the power cable. Only damp microfibre cloth can be used for cleaning. Technical changes are subjected without notice. Do not dispose the luminaire or its parts as household waste, but make the proper recycling.

Maximum of the luminaires in one line			10A B	16A B	10A C	16A C	
Length	Σ1m	Σ1m	Σ1m luminaires	Σ luminaires	Σ luminaires	Σ luminaires	
1.2ft	1300	1600	2200	32	50	52	85
1.4ft	2600			32	50	52	85
1.4ft	3200	4400	6400	10	16	16	26
1.4ft	8000			11	17	17	27
1.5ft	3250	4000	5500	10	16	16	26
1.5ft	8000	10000		11	17	17	27

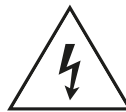

The light source in this luminaire may be replaced only by the manufacturer or its contractual service technician or similarly qualified person!

